

NOTICE!!

These documents have been scanned!

Do not place un-scanned documents beneath this notice!

Do not remove this notice from this file!

GPO Jacket No. 560-102
Print Order 61540
Rise Business Services, LLC
Job=AZ15 4/26/2019



Box Number= AZ15001



Claim Begin-End: AMC450400-AMC450409

1 Initial Receipt



AZ15001-5

AMC450400-AMC453366

United States Department of the Interior
Bureau of Land Management
 DIV OF LANDS, MINRLS & ENERGY
 ONE N CENTRAL AVE
 PHOENIX, AZ 85004 -4427
 Phone: 602-417-9200

Receipt

No: 4139993

Transaction #: 4253810

Date of Transaction: 04/16/2018

CUSTOMER:

EDGAR HENRY
 1012 FLATBUSH AVE
 BROOKLYN, NY 11226-5005 US

ENTERED
 APR 19 2018
 BY: Ram

LINE #	QTY	DESCRIPTION	REMARKS	UNIT PRICE	TOTAL
1	10.00	LOCATABLE MINERALS / MINING CLAIMS- NEW, UNADJUD, ONE OR MORE AUTH NOS / NEW MINING CLAIM PROCESSING FEE CASES: AMC450400/\$20.00, AMC450401/\$20.00, AMC450402/\$20.00, AMC450403/\$20.00, AMC450404/\$20.00, AMC450405/\$20.00, AMC450406/\$20.00, AMC450407/\$20.00, AMC450408/\$20.00, AMC450409/\$20.00		- n/a -	200.00
2	10.00	LOCATABLE MINERALS / MINING CLAIMS- NEW, UNADJUD, ONE OR MORE AUTH NOS / NEW MINING CLAIMS LOCATION FEE CASES: AMC450400/\$37.00, AMC450401/\$37.00, AMC450402/\$37.00, AMC450403/\$37.00, AMC450404/\$37.00, AMC450405/\$37.00, AMC450406/\$37.00, AMC450407/\$37.00, AMC450408/\$37.00, AMC450409/\$37.00		- n/a -	370.00
3	10.00	LOCATABLE MINERALS / MINING CLAIMS- NEW, UNADJUD, ONE OR MORE AUTH NOS / NEW MINING CLAIMS MAINTENANCE FEE CASES: AMC450400/\$155.00, AMC450401/\$155.00, AMC450402/\$155.00, AMC450403/\$155.00, AMC450404/\$155.00, AMC450405/\$155.00, AMC450406/\$155.00, AMC450407/\$155.00, AMC450408/\$155.00, AMC450409/\$155.00		- n/a -	1550.00
TOTAL:					\$2,120.00

PAYMENT INFORMATION

1	AMOUNT:	2120.00	POSTMARKED:	N/A
	TYPE:	CHECK	RECEIVED:	04/13/2018

CHECK NO:	6357
NAME:	HENRY, EDGAR 1012 FLATBUSH AVE BROOKLYN NY 11226-5005 US

REMARKS

This receipt was generated by the automated BLM Collections and Billing System and is a paper representation of a portion of the official electronic record contained therein.

NOTICE!!

These documents have been scanned!

Do not place un-scanned documents beneath this notice!

Do not remove this notice from this file!

GPO Jacket No. 560-102
Print Order 61540
Rise Business Services, LLC
Job=AZ15 4/26/2019



Box Number= AZ15001



Claim Begin-End: AMC450400-AMC450409

2 Correspondence



AZ15001-5

AMC450400-AMC453366

**NO
DOCUMENTS
FOUND**

NO DOCUMENTS FOUND
NO DOCUMENTS FOUND

NOTICE!!

These documents have been scanned!

Do not place un-scanned documents beneath this notice!

Do not remove this notice from this file!

GPO Jacket No. 560-102
Print Order 61540
Rise Business Services, LLC
Job=AZ15 4/26/2019



Box Number= AZ15001



Claim Begin-End: AMC450400-AMC450409

3 Transfers



AZ15001-5

AMC450400-AMC453366

**NO
DOCUMENTS
FOUND**

NO DOCUMENTS FOUND
NO DOCUMENTS FOUND

NOTICE!!

These documents have been scanned!

Do not place un-scanned documents beneath this notice!

Do not remove this notice from this file!

GPO Jacket No. 560-102
Print Order 61540
Rise Business Services, LLC
Job=AZ15 4/26/2019



Box Number= AZ15001



Claim Begin-End: AMC450400-AMC450409

4 Annual Filings



AZ15001-5

AMC450400-AMC453366

450400



MANAGEMENT
L AVENUE SUITE 800
85004-4427



1-23
210

5997

EDGAR HENRY

DATE 8/12/19.

PAY TO THE ORDER OF BUREAU OF LAND MANAGEMENT \$ 1,650 ⁰⁰/₁₀₀

ONE THOUSAND SIX HUNDRED & FIFTY ⁰⁰/₁₀₀ DOLLARS

CHASE
JPMorgan Chase Bank, N.A.
www.Chase.com

MEMO EDGAR 10-AMC# 450400
CLAIMS RENEWAL 10-CLAIMS.

Edgar Henry MP

EDGAR HENRY
1012 Flat Bush AVENUE
Brooklyn N.Y. 11226

PHOENIX, ARIZONA

2019 AUG 19 P 3:26

RECEIVED
BLM AZ STATE OFFICE

ENTERED
AUG 22 2019
BY: [Signature]

2020 Maint Fees

NO. OF CLAIMS 10
AMOUNT \$1650.
RECEIPT NO. 4538379
INIT. EB
** BLM-ASO**

EDGAR HENRY
1017 Flat Bush Avenue
Brooklyn N.Y. 11226.

RECEIVED
BLM AZ STATE OFFICE
2019 AUG 19 P 3:26
PHOENIX, ARIZONA

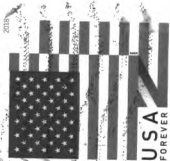

BUREAU OF LAND MANAGEMENT
ONE NORTH CENTRAL AVENUE SUITE 800
PHOENIX AZ 85004-4427

8500434427 0041

2020 Maint Fees

NO. OF CLAIMS

AMOUNT

RECEIPT NO.

INIT.

** BLM-ASO **

10
\$1650.
4538379
ESG

Claim Name	Serial Number	Lead Serial Number	Claimant Name	Mer	Twn	Rng	Sec	Subdiv	County	Geo State	Loc Date	Closed Date
EDGAR 04	AMC450403	AMC450400	HENRY EDGAR	14	0090S	0110E	028	NW	PINAL	AZ	02/23/2018	
EDGAR 10	AMC450409	AMC450400	HENRY EDGAR	14	0090S	0110E	028	NE	PINAL	AZ	02/23/2018	
EDGAR-01	AMC450400	AMC450400	HENRY EDGAR	14	0090S	0110E	028	NW	PINAL	AZ	02/23/2018	
EDGAR-02	AMC450401	AMC450400	HENRY EDGAR	14	0090S	0110E	028	NW	PINAL	AZ	02/23/2018	
EDGAR-03	AMC450402	AMC450400	HENRY EDGAR	14	0090S	0110E	028	NW	PINAL	AZ	02/23/2018	
EDGAR-05	AMC450404	AMC450400	HENRY EDGAR	14	0090S	0110E	028	NW	PINAL	AZ	02/23/2018	
EDGAR-06	AMC450405	AMC450400	HENRY EDGAR	14	0090S	0110E	028	NW	PINAL	AZ	02/23/2018	
EDGAR-07	AMC450406	AMC450400	HENRY EDGAR	14	0090S	0110E	028	NW	PINAL	AZ	02/23/2018	
EDGAR-08	AMC450407	AMC450400	HENRY EDGAR	14	0090S	0110E	028	NW	PINAL	AZ	02/23/2018	
EDGAR-09	AMC450408	AMC450400	HENRY EDGAR	14	0090S	0110E	028	NE	PINAL	AZ	02/23/2018	

United States Department of the Interior
Bureau of Land Management
DIV OF LANDS, MINRLS & ENERGY
ONE N CENTRAL AVE
PHOENIX, AZ 85004 -4427
Phone: 602-417-9200

Receipt

No: 4538379

Transaction #: 4659311**Date of Transaction:** 08/21/2019

CUSTOMER:

EDGAR HENRY
1012 FLATBUSH AVE
BROOKLYN, NY 11226-5005 US

LINE #	QTY	DESCRIPTION	REMARKS	UNIT PRICE	TOTAL
1	1.00	LOCATABLE MINERALS / MINING CLAIMS- NOT NEW-UNADJUD, ONE AUTH NO. ONLY / MINING CLAIM MONEY RECEIVED CASES: AMC450400/\$1650.00	2020 MAINT (10)	- n/a -	1650.00
TOTAL:					\$1,650.00

PAYMENT INFORMATION			
1	AMOUNT:	1650.00	POSTMARKED: N/A
	TYPE:	CHECK	RECEIVED: 08/21/2019
	CHECK NO:	5997	
	NAME:	HENRY, EDGAR 1012 FLATBUSH AVE BROOKLYN NY 11226-5005 US	

REMARKS

This receipt was generated by the automated BLM Collections and Billing System and is a paper representation of a portion of the official electronic record contained therein.

Run Date: 08/07/18

Run Time: 04:41 PM

**DEPARTMENT OF THE INTERIOR
BUREAU OF LAND MANAGEMENT
MINING CLAIMS**

MC Maintenance Fees Paid Through the BLM Pay Portal

CBS Receipt: 4226389

Printed For Lead File # AMC450400

Agency Tracking ID: 1533228320

Assessment Year: 2019

Number of BLM Serial Nr: 10

Paid On: 08/02/2018

Total Amount Paid: \$1,550.00

Claim Name	BLM Serial No	Lead File No	Amount Paid
EDGAR 01	AMC450400	AMC450400	\$155.00
EDGAR 02	AMC450401	AMC450400	\$155.00
EDGAR 03	AMC450402	AMC450400	\$155.00
EDGAR 04	AMC450403	AMC450400	\$155.00
EDGAR 05	AMC450404	AMC450400	\$155.00
EDGAR 06	AMC450405	AMC450400	\$155.00
EDGAR 07	AMC450406	AMC450400	\$155.00
EDGAR 08	AMC450407	AMC450400	\$155.00
EDGAR 09	AMC450408	AMC450400	\$155.00
EDGAR 10	AMC450409	AMC450400	\$155.00

United States Department of the Interior
Bureau of Land Management
BUSINESS & SUPPORT SVCS DIV
ONE N CENTRAL AVE SUITE 800
PHOENIX, AZ 85004 -4427
Phone: 602-417-9200

Receipt

No: 4226389

Transaction #: 4341639	
Date of Transaction: 08/02/2018	
CUSTOMER:	
	EDGAR HENRY 1012 FLATBUSH AVE BROOKLYN,NY 11226 US

LINE #	QTY	DESCRIPTION	REMARKS	UNIT PRICE	TOTAL
1	1.00	LOCATABLE MINERALS / MINING CLAIMS- NOT NEW-UNADJUD,ONE AUTH NO. ONLY / MINING CLAIM MONEY RECEIVED CASES: AMC450400/\$1550.00		- n/a -	1550.00
TOTAL:					\$1,550.00

PAYMENT INFORMATION				
NOTE: Items will appear on credit card statement as "BLM O Mining Claim".				
1	AMOUNT:	1550.00	POSTMARKED:	N/A
	TYPE:	CREDIT CARD	RECEIVED:	08/02/2018
	NAME:	EDGAR HENRY 1012 FLATBUSH AVE BROOKLYN NY 11226 US		
	CARD NO:	XXXXXXXXXXXX6368	AUTH CODE:	02244A
	NAME ON CARD:	EDGAR HENRY		
	SIGNATURE:			

REMARKS

This receipt was generated by the automated BLM Collections and Billing System and is a paper representation of a portion of the official electronic record contained therein.

NOTICE!!

These documents have been scanned!

Do not place un-scanned documents beneath this notice!

Do not remove this notice from this file!

GPO Jacket No. 560-102
Print Order 61540
Rise Business Services, LLC
Job=AZ15 4/26/2019



Box Number= AZ15001



Claim Begin-End: AMC450400-AMC450409

5 Miscellaneous



AZ15001-5

AMC450400-AMC453366

Golden Oasis Development, LLC
7427 N. Syracuse St.
Portland, Oregon 97203
503-285-4652
dmwhite882003@yahoo.com

April 3, 2003

To: Recorder

Dear BLM,

Please record the following claims. See the attached letter from Ron Parker who staked the claims properly. Send the receipt back to Edgar Henry sy 1012 Flatbush Ave., Brooklyn, New York 11226. If you have any questions, please call me, Marcus White at 503-285-4652.

Marcus White, Managing Member
503-285-4652

Marcus White

RECEIVED
BLM
2003 APR 13 P 12:54
PHOENIX, ARIZONA

R & D Adventures LLC
14700 Shotgun Pl.
Oro Valley, AZ. 85737
(520) 825-5359
rocktoss@comcast.net

PHOENIX, ARIZONA

2018 APR 13 P 12:55

February 26, 2018

Edgar Henry

I have completed the papering of the Edgar Claims 1 through 10. You will need to send these claim notices with payment of \$2,120 (\$212 per claim) to:

Be aura of Land Management
One North Central Ave, Suite 800
Phoenix, AZ 85004-4427

Then request that they return the claim notices to you. When you get the notices back from the BLM you will need to send the notices and payment of \$100 to be registered with Pinal County Recorder P.O. Box 848 Florence, AZ 85132

Ron Parker
14700 N. Shotgun Place
Oro Valley, AZ 85755

Thank you,

Ron Parker

Hi Marcus,
PLEASE REGISTER THE ABOVE
THE ATTACHED ON MY BEHALF. EDGAR 1 - EDGAR.
Thanks
EDGAR.

R & D Adventures LLC
14700 Shotgun Pl.
Oro Valley, AZ. 85737
(520) 825-5359
rocktoss@comcast.net

RECEIVED
BLM
2018 APR 13 P 12:55
PHOENIX, ARIZONA

February 26, 2018

Edgar Henry

I have completed the papering of the Edgar Claims 1 through 10.
You will need to send these claim notices with payment of
\$2,120 (\$212 per claim) to:

Be aura of Land Management
One North Central Ave, Suite 800
Phoenix, AZ 85004-4427

Then request that they return the claim notices to you.
When you get the notices back from the BLM you will need to
send the notices and payment of \$100 to be registered with Pinal
County Recorder P.O. Box 848 Florence, AZ 85132

Ron Parker
14700 N. Shotgun Place
Oro Valley, AZ 85755

Thank you,



Hi Mads,
PLEASE REGISTER THE ABOVE
THE ATTACHED ON MY BEHALF. EDGAR 1 - EDGAR 10.
THANKS
EDGAR

NOTICE!!

These documents have been scanned!

Do not place un-scanned documents beneath this notice!

Do not remove this notice from this file!

GPO Jacket No. 560-102
Print Order 61540
Rise Business Services, LLC
Job=AZ15 4/26/2019



Box Number= AZ15001



Claim Begin-End: AMC450400-AMC450409

6 Location Notices-Amendments and Supporting Documents



AZ15001-5

AMC450400-AMC453366

MINING CLAIM STATUS | PORT

Data Entered: 4/19/18 RAM

MTP Checked By: 4/19/18 RAM

GEO Checked By: 4/19/18 RAM

LEAD SERIAL NUMBER: AMC 450400 thru AMC 450409

NUMBER OF CLAIMS & TYPE:

10 LODE
 PLACER
 ASSOCIATION PLACER
 MILL SITE
 TUNNEL SITE

CHARGES:

Processing Fee @ \$20 = \$ 200
 Location Fee @ \$37 = \$ 370
 Maintenance Fee @ \$155 = \$ 1,550
 Add'l Maint Fee for Assoc Placer = \$
SUBTOTAL \$
 Other Fees \$
 Other Fees \$
TOTAL \$ 2,120

TOTAL ACREAGE: Per Claim
 (Placer Only)

NUMBER OF LOCATORS:

DOCUMENTS RECEIVED VIA: Over-the-Counter [] Mail ☒ TIMELY FILED: Yes ☒ No []

LEGAL DESCRIPTION: T 95 R 11E SEC 28
 T R SEC
 T R SEC
 T R SEC
 T R SEC

BLM [] FOREST SERVICE [] SUBJ TO PL 359: Yes [] No []
 WILDERNESS AREA []

SPLIT ESTATE: N/A [] SX [] PX [] OTHER []
 SRHA [] Was proper Notice filed if located on SHRA Land? Yes [] No []

RECONVEYED MINERALS ON BLM LAND REQUIRE OPENING ORDER FROM 1944 TO 1993:

Open to Entry On N/A []

COMMENTS/STATUS: VOID [] PARTIALLY VOID [] PVT MINERALS [] WITHDRAWN LANDS []
 OTHER []

AMC450400

[] Claimant acknowledges that portions of the following claim(s) site(s) may be void or voidable.

Printed Name of Claimant Signature of Claimant

*****FINAL ADJUDICATION*****

DATE 8/8/2018 INITIALS

LOCATION NOTICE FOR PLACER MINING CLAIM

NOTICE IS HEREBY GIVEN that the Edgar-01 placer mining claim has been located by Edgar Henry whose current mailing address is 1012 Flatbush AVE. Brooklyn, NY 11223-5005.

BLM	2018 APR 13 P 12:55
DATE	
STAMP	

The general course of this claim is East to West and is situated in Pinal County, Arizona.

The claim is 1,320 feet in length and 660 feet in width. This claim runs from the location monument on which the location notice is posted (being the northeast corner of the said claim), approximately 660 feet in a southerly direction to the south end line and 1,320 feet in a westerly direction to the west end line.

The claim is marked by four 2"x2"x4' monuments, one at each corner of the claim.

The location monument on which this notice is posted is situated within Section 28, Township 9 South, Range 11 East, Gila Salt River Base and Meridian, Arizona. This claim encompasses portions of the following quarter section (s), section (s), Township (s) and Range (s)

N1/2 NE1/4 NW1/4 Section 28, Township 9 South, Range 11 East, Gila Salt River Base and Meridian, Arizona.

The locality of this claim with reference to some natural object or permanent monument and additional information (if any) concerning its locality are as follows: NONE

DATED AND POSTED on the ground this 23 day of February, 2018.

LOCATOR (s) Owners

Edgar Henry

By

Ron Parker

Ron Parker/Agent for Owners

AHC450400

T9S, R11E Section 28

Location Map

Edgar Claim 01 to Edgar Claim 10

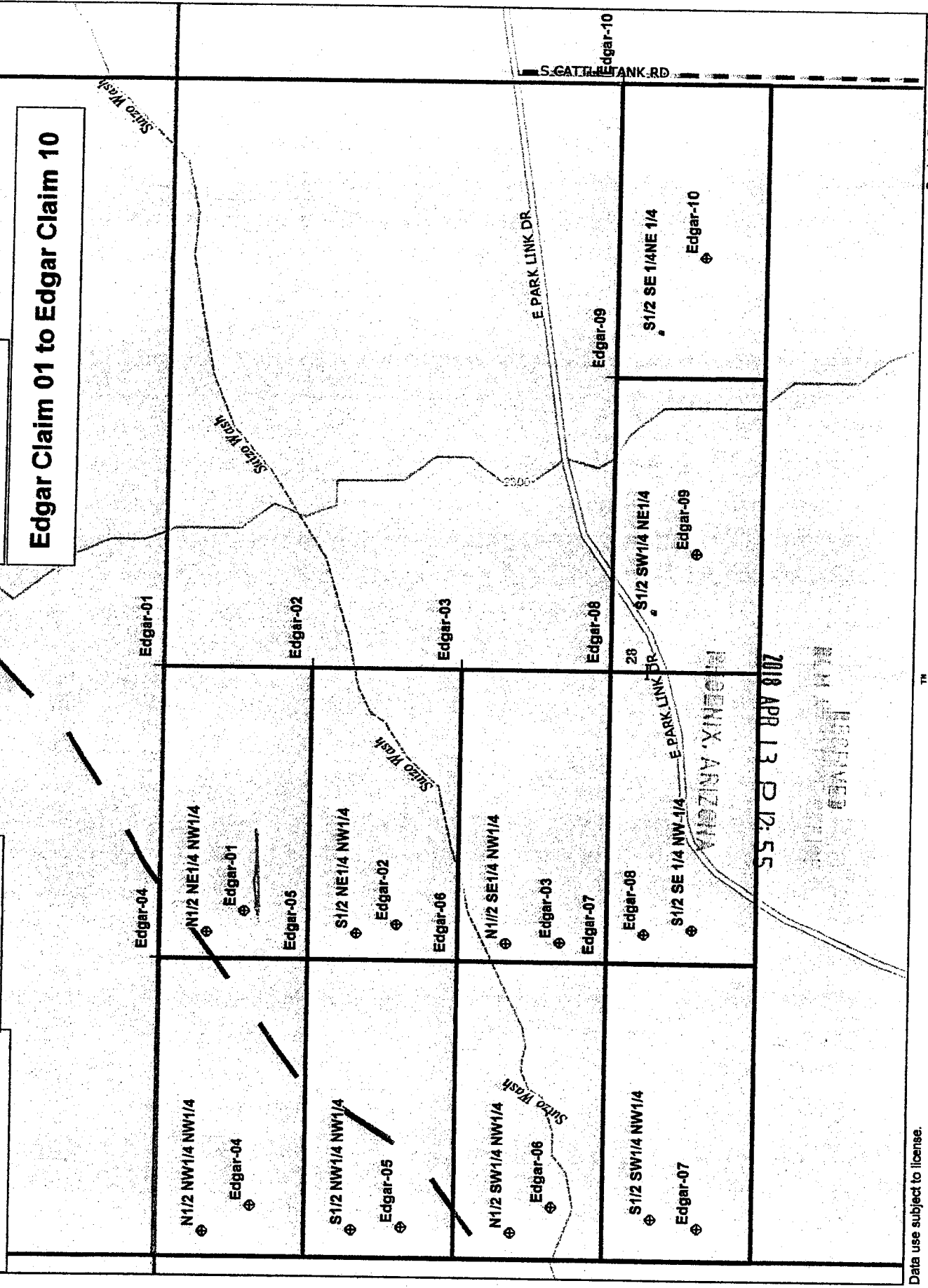

Data use subject to license.

© DeLorme, Topo North America™ 10.

www.delorme.com

00045040A

2018 APR 13 07:55

Scale 1:7,200

1" = 800.0 ft Data Zoom 14-5

LOCATION NOTICE FOR PLACER MINING CLAIM

NOTICE IS HEREBY GIVEN that the Edgar-02 placer mining claim has been located by Edgar Henry whose current mailing address is 1012 Flatbush AVE. Brooklyn, NY 11223-5005

The general course of this claim is East to West and is situated in P

BLM	2018 APR 13 P 12:5	RECEIVED
DATE		
STAMP		

The claim is 1,320 feet in length and 660 feet in width. This claim runs from the location monument on which the location notice is posted (being the northeast corner of the said claim), approximately 660 feet in a southerly direction to the south end line and 1,320 feet in a westerly direction to the west end line.

The claim is marked by four 2"x2"x4' monuments, one at each corner of the claim.

The location monument on which this notice is posted is situated within Section 28, Township 9 South, Range 11 East, Gila Salt River Base and Meridian, Arizona. This claim encompasses portions of the following quarter section (s), section (s), Township (s) and Range (s)

S1/2 NE1/4 NW1/4 of Section 28, Township 9 South, Range 11 East, Gila Salt River Base and Meridian, Arizona.

The locality of this claim with reference to some natural object or permanent monument and additional information (if any) concerning its locality are as follows: NONE

DATED AND POSTED on the ground this 23 day of February, 2018.

LOCATOR (s) Owners

Edgar Henry

By



Ron Parker/Agent for Owners

AHC450401

T9S, R11E

Section 28

Location Map

Edgar Claim 01 to Edgar Claim 10

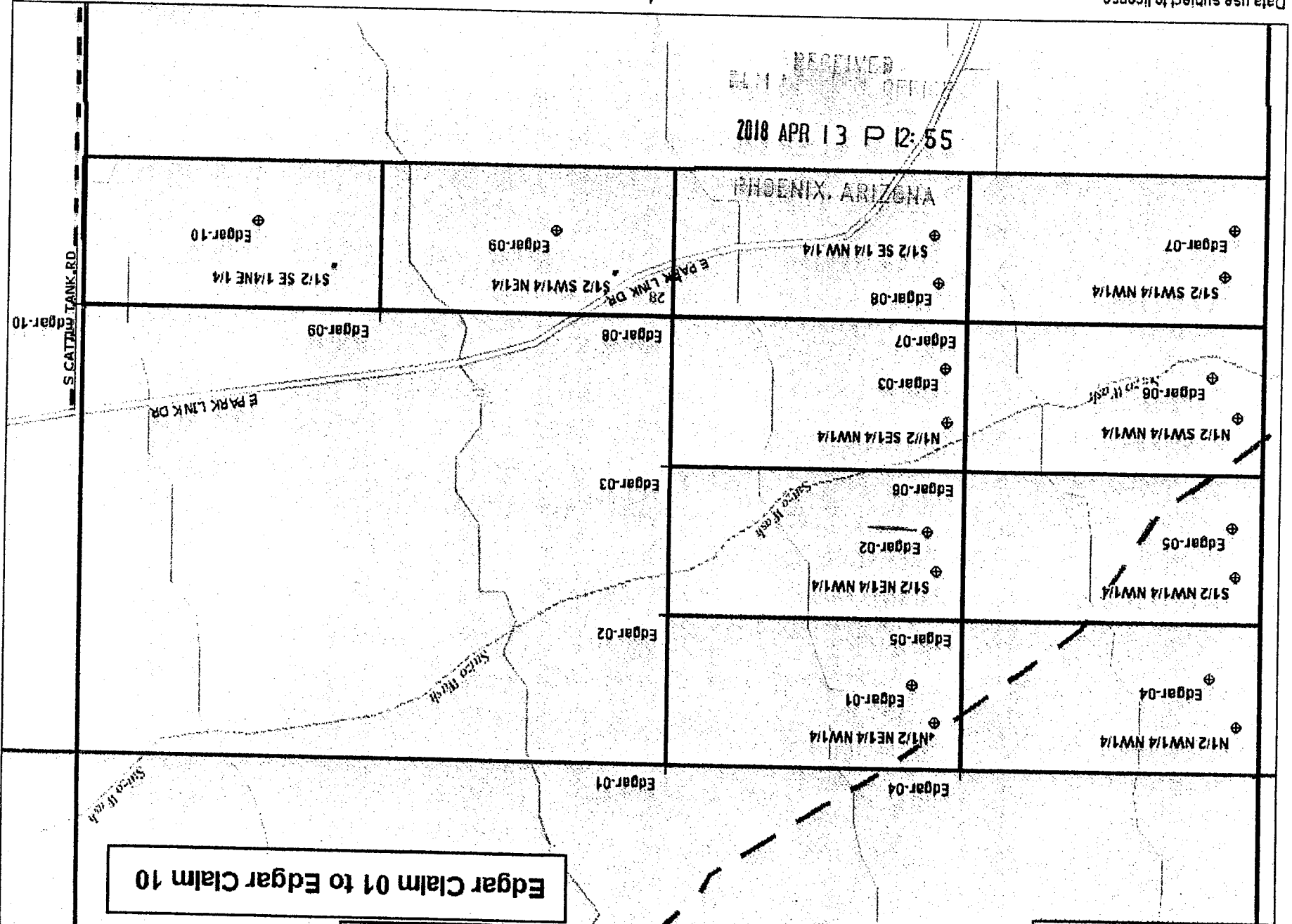

Data use subject to license.

© DeLorme, Topo North America™ 10.

www.delorme.com

RECEIVED
ELI M. JONES OFFICE
2018 APR 13 P 12:55

PHOENIX, ARIZONA

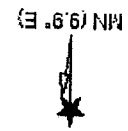

104050401

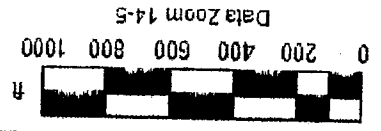

LOCATION NOTICE FOR PLACER MINING CLAIM

NOTICE IS HEREBY GIVEN that the Edgar-03 placer mining claim has been located by Edgar Henry whose current mailing address is 1012 Flatbush AVE. Brooklyn, NY 11223-5005.

BLM	
DATE	2018 APR 13 P 12:5
STAMP	MINING, ARIZONA

The general course of this claim is East to West and is situated in Pinal County, Arizona.

The claim is 1,320 feet in length and 660 feet in width. This claim runs from the location monument on which the location notice is posted (being the northeast corner of the said claim), approximately 660 feet in a southerly direction to the south end line and 1,320 feet in a westerly direction to the west end line.

The claim is marked by four 2"x2"x4' monuments, one at each corner of the claim.

The location monument on which this notice is posted is situated within Section 28, Township 9 South, Range 11 East, Gila Salt River Base and Meridian, Arizona. This claim encompasses portions of the following quarter section (s), section (s), Township (s) and Range (s)

N1/2 SE1/4 NW1/4 of Section 28, Township 9 South, Range 11 East, Gila Salt River Base and Meridian, Arizona.

The locality of this claim with reference to some natural object or permanent monument and additional information (if any) concerning its locality are as follows: NONE

DATED AND POSTED on the ground this 23 day of February, 2018.

LOCATOR (s) Owners

Edgar Henry

By



Ron Parker/Agent for Owners

AHC450402

T9S, R11E

Section 28

Location Map

Edgar Claim 01 to Edgar Claim 10

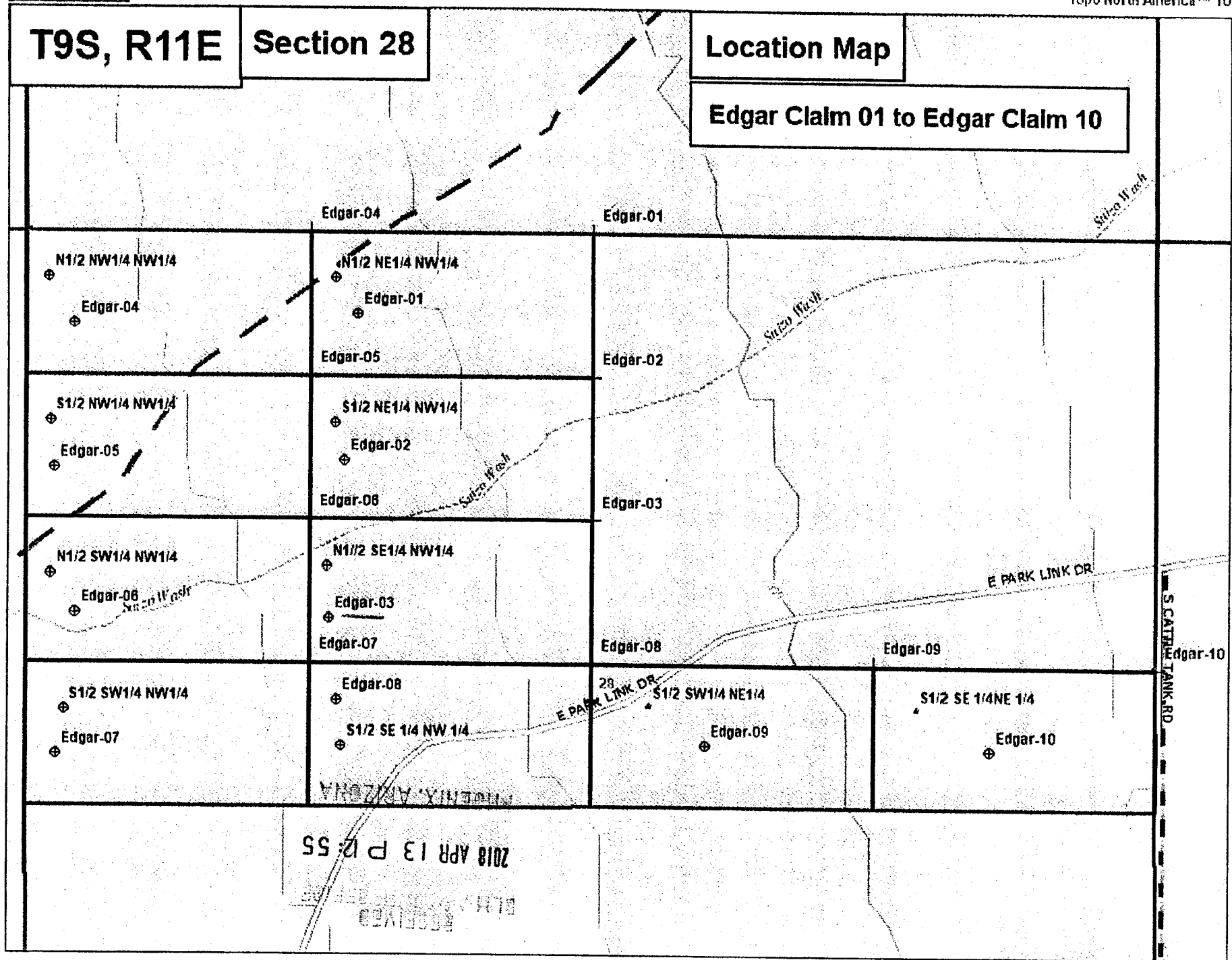

Data use subject to license.

© DeLorme, Topo North America™ 10.

www.delorme.com



2018 APR 13 P 12:55

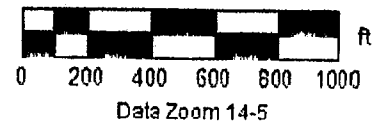

LOCATION NOTICE FOR PLACER MINING CLAIM

NOTICE IS HEREBY GIVEN that the Edgar-04 placer mining claim has been located by Edgar Henry whose current mailing address is 1012 Flatbush AVE. Brooklyn, NY 11223-5005.

BLM	2018 APR 13 P 12:55
DATE	PHOENIX, ARIZONA
STAMP	

The general course of this claim is East to West and is situated in Pinal County, Arizona.

The claim is 1,320 feet in length and 660 feet in width. This claim runs from the location monument on which the location notice is posted (being the northeast corner of the said claim), approximately 660 feet in a southerly direction to the south end line and 1,320 feet in a westerly direction to the west end line.

The claim is marked by four 2"x2"x4' monuments, one at each corner of the claim.

The location monument on which this notice is posted is situated within Section 28, Township 9 South, Range 11 East, Gila Salt River Base and Meridian, Arizona. This claim encompasses portions of the following quarter section (s), section (s), Township (s) and Range (s)

N1/2 NW1/4 NW1/4 of Section 28, Township 9 South, Range 11 East, Gila Salt River Base and Meridian, Arizona.

The locality of this claim with reference to some natural object or permanent monument and additional information (if any) concerning its locality are as follows: NONE

DATED AND POSTED on the ground this 23 day of February, 2018.

LOCATOR (s) Owners

Edgar Henry

By

Ron Parker

Ron Parker/Agent for Owners

AHC450403

T9S, R11E

Section 28

AMC 450403

Location Map

Edgar Claim 01 to Edgar Claim 10

2018 APR 13 P 12:55

PHOENIX, ARIZONA

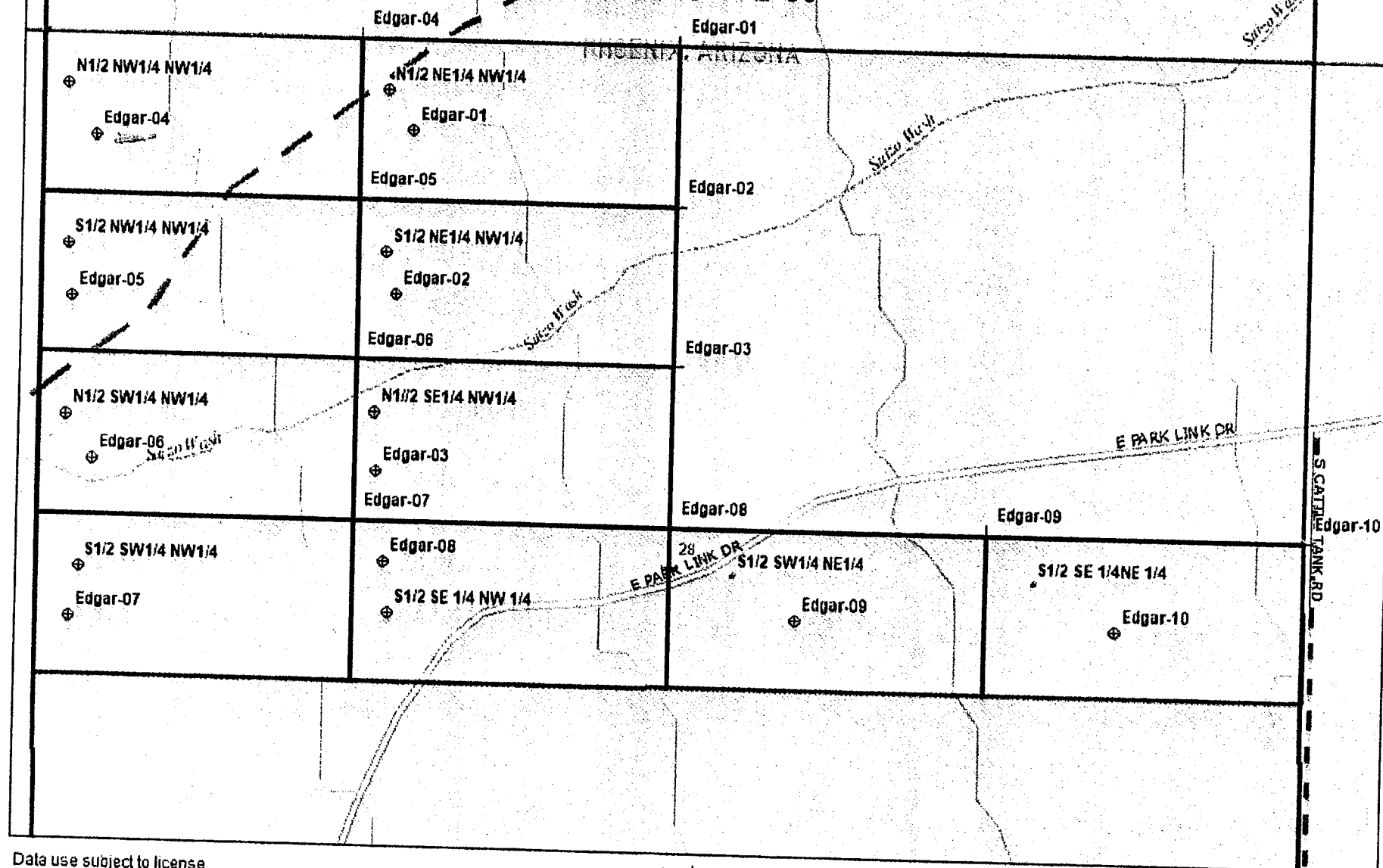

Data use subject to license.

© DeLorme. Topo North America™ 10.

www.delorme.com

MN (9.9° E)

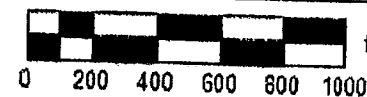

LOCATION NOTICE FOR PLACER MINING CLAIM

NOTICE IS HEREBY GIVEN that the Edgar-05 placer mining claim has been located by Edgar Henry whose current mailing address is 1012 Flatbush AVE. Brooklyn, NY 11223-5005.

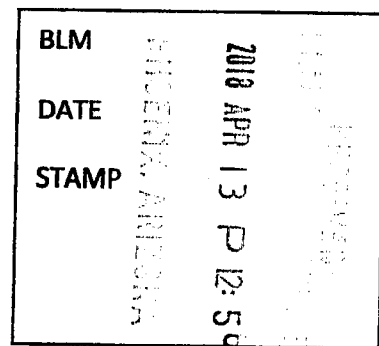

The general course of this claim is East to West and is situated in Pinal County, Arizona.

The claim is 1,320 feet in length and 660 feet in width. This claim runs from the location monument on which the location notice is posted (being the northeast corner of the said claim), approximately 660 feet in a southerly direction to the south end line and 1,320 feet in a westerly direction to the west end line.

The claim is marked by four 2"x2"x4' monuments, one at each corner of the claim.

The location monument on which this notice is posted is situated within Section 28, Township 9 South, Range 11 East, Gila Salt River Base and Meridian, Arizona. This claim encompasses portions of the following quarter section (s), section (s), Township (s) and Range (s)

S1/2 NW1/4 NW1/4 of Section 28, Township 9 South, Range 11 East, Gila Salt River Base and Meridian, Arizona.

The locality of this claim with reference to some natural object or permanent monument and additional information (if any) concerning its locality are as follows: NONE

DATED AND POSTED on the ground this 23 day of February, 2018.

LOCATOR (s) Owners

Edgar Henry

By

A handwritten signature in cursive script that reads "Ron Parker".

Ron Parker/Agent for Owners

ARIC450404

T9S, R11E

Section 28

Location Map

Edgar Claim 01 to Edgar Claim 10

AHC450404

2018 APR 13 P 12:56

PHILIP A. ARIZONA

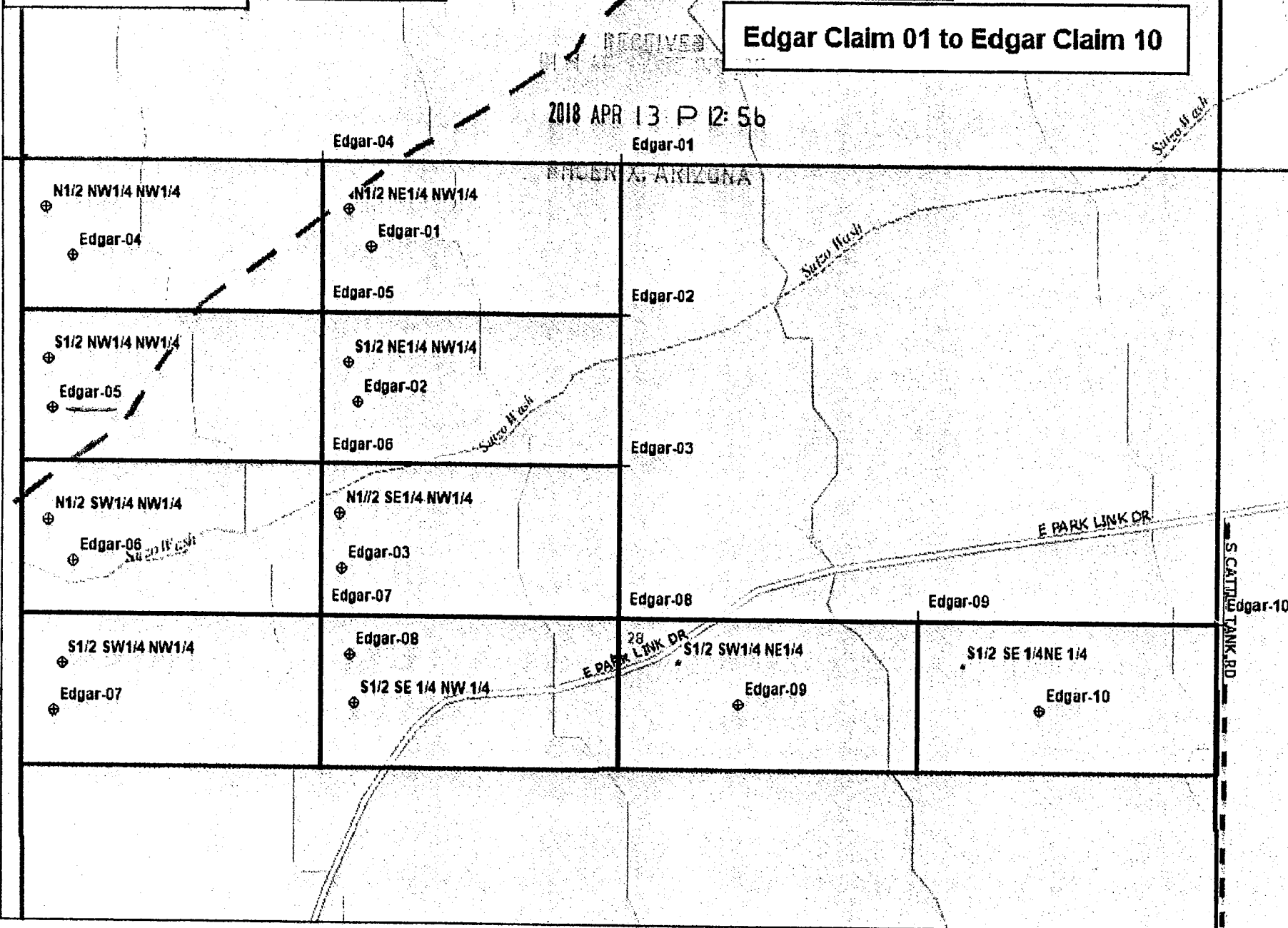

Data use subject to license.

© DeLorme. Topo North America™ 10.

www.delorme.com

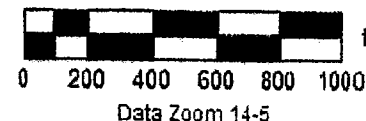

LOCATION NOTICE FOR PLACER MINING CLAIM

NOTICE IS HEREBY GIVEN that the Edgar-06 placer mining claim has been located by Edgar Henry whose current mailing address is 1012 Flatbush AVE. Brooklyn, NY 11223-5005.

BLM	2018 APR 13 P 12:56
DATE	2018 APR 13 P 12:56
STAMP	2018 APR 13 P 12:56

The general course of this claim is East to West and is situated in Pinal County, Arizona.

The claim is 1,320 feet in length and 660 feet in width. This claim runs from the location monument on which the location notice is posted (being the northeast corner of the said claim), approximately 660 feet in a southerly direction to the south end line and 1,320 feet in a westerly direction to the west end line.

The claim is marked by four 2"x2"x4' monuments, one at each corner of the claim.

The location monument on which this notice is posted is situated within Section 28, Township 9 South, Range 11 East, Gila Salt River Base and Meridian, Arizona. This claim encompasses portions of the following quarter section (s), section (s), Township (s) and Range (s)

N1/2 SW1/4 NW1/4 of Section 28, Township 9 South, Range 11 East, Gila Salt River Base and Meridian, Arizona.

The locality of this claim with reference to some natural object or permanent monument and additional information (if any) concerning its locality are as follows: NONE

DATED AND POSTED on the ground this 23 day of February, 2018.

LOCATOR (s) Owners

Edgar Henry

By



Ron Parker/Agent for Owners

AHC450405

T9S, R11E

Section 28

Location Map

AHC450405

Edgar Claim 01 to Edgar Claim 10

2018 APR 13 P 12: 56

PHOENIX, ARIZONA

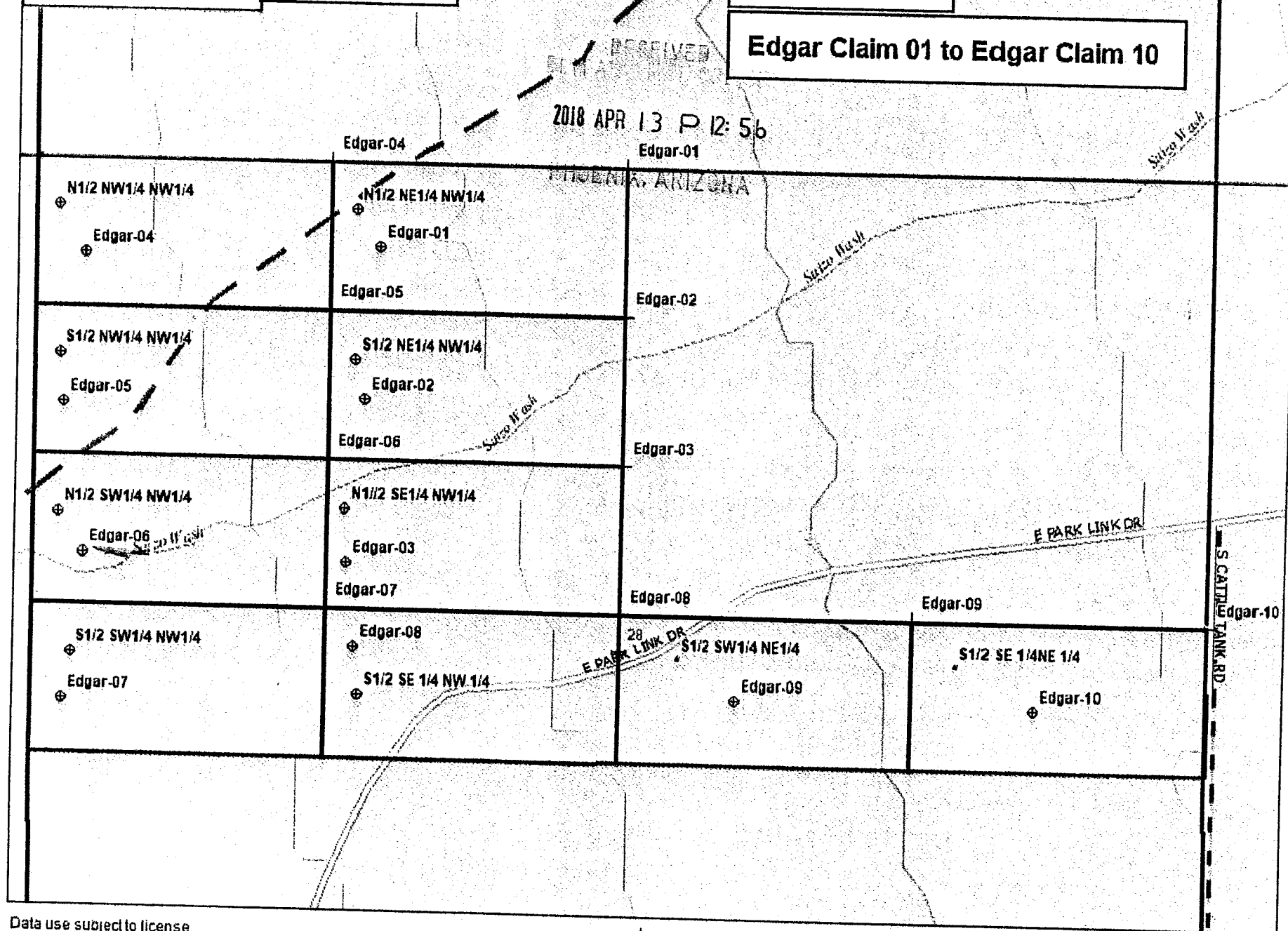

Data use subject to license.

© DeLorme. Topo North America™ 10.

www.delorme.com

M 11 (9.9° E)



LOCATION NOTICE FOR PLACER MINING CLAIM

NOTICE IS HEREBY GIVEN that the Edgar-07 placer mining claim has been located by Edgar Henry whose current mailing address is 1012 Flatbush AVE. Brooklyn, NY 11223-5005.

BLM	
DATE	2018 APR 13 P 12:56
STAMP	PINAL COUNTY, ARIZONA

The general course of this claim is East to West and is situated in Pinal County, Arizona.

The claim is 1,320 feet in length and 660 feet in width. This claim runs from the location monument on which the location notice is posted (being the northeast corner of the said claim), approximately 660 feet in a southerly direction to the south end line and 1,320 feet in a westerly direction to the west end line.

The claim is marked by four 2"x2"x4' monuments, one at each corner of the claim.

The location monument on which this notice is posted is situated within Section 28, Township 9 South, Range 11 East, Gila Salt River Base and Meridian, Arizona. This claim encompasses portions of the following quarter section (s), section (s), Township (s) and Range (s)

S1/2 SW1/4 NW1/4 of Section 28, Township 9 South, Range 11 East, Gila Salt River Base and Meridian, Arizona.

The locality of this claim with reference to some natural object or permanent monument and additional information (if any) concerning its locality are as follows: NONE

DATED AND POSTED on the ground this 23 day of February, 2018.

LOCATOR (s) Owners

Edgar Henry

By

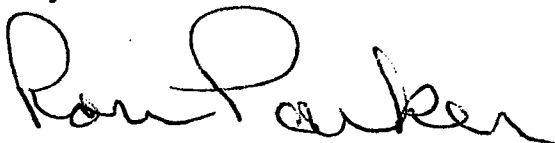

Ron Parker/Agent for Owners

AHC450406

T9S, R11E

Section 28

Location Map

Edgar Claim 01 to Edgar Claim 10

2018 APR 13 P 12:56

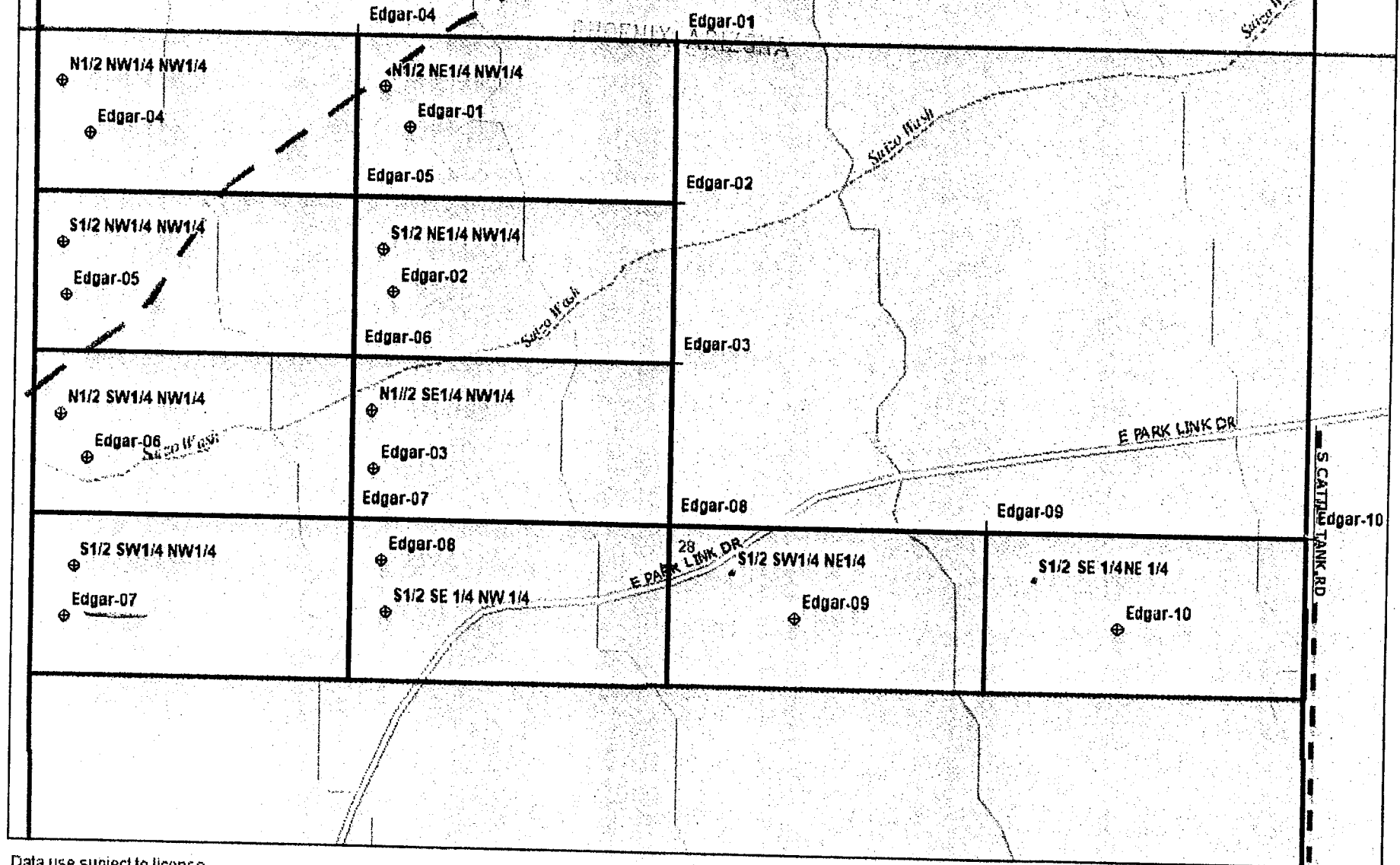

Data use subject to license.

© DeLorme. Topo North America™ 10.

www.delorme.com

MN (9.9° E)



LOCATION NOTICE FOR PLACER MINING CLAIM

NOTICE IS HEREBY GIVEN that the Edgar-08 placer mining claim has been located by Edgar Henry whose current mailing address is 1012 Flatbush AVE. Brooklyn, NY 11223-5005.

BLM	
DATE	2018 APR 13 P 12:56
STAMP	RECEIVED

The general course of this claim is East to West and is situated in Pinal County, Arizona.

The claim is 1,320 feet in length and 660 feet in width. This claim runs from the location monument on which the location notice is posted (being the northeast corner of the said claim), approximately 660 feet in a southerly direction to the south end line and 1,320 feet in a westerly direction to the west end line.

The claim is marked by four 2"x2"x4' monuments, one at each corner of the claim.

The location monument on which this notice is posted is situated within Section 28, Township 9 South, Range 11 East, Gila Salt River Base and Meridian, Arizona. This claim encompasses portions of the following quarter section (s), section (s), Township (s) and Range (s)

S1/2 SE1/4 NW1/4 of Section 28, Township 9 South, Range 11 East, Gila Salt River Base and Meridian, Arizona.

The locality of this claim with reference to some natural object or permanent monument and additional information (if any) concerning its locality are as follows: NONE

DATED AND POSTED on the ground this 23 day of February, 2018.

LOCATOR (s) Owners

Edgar Henry

By



Ron Parker/Agent for Owners

AHC450407

T9S, R11E

Section 28

Location Map

AHC450407

Edgar Claim 01 to Edgar Claim 10

2018 APR 13 P 12:56

PHOENIX, ARIZONA

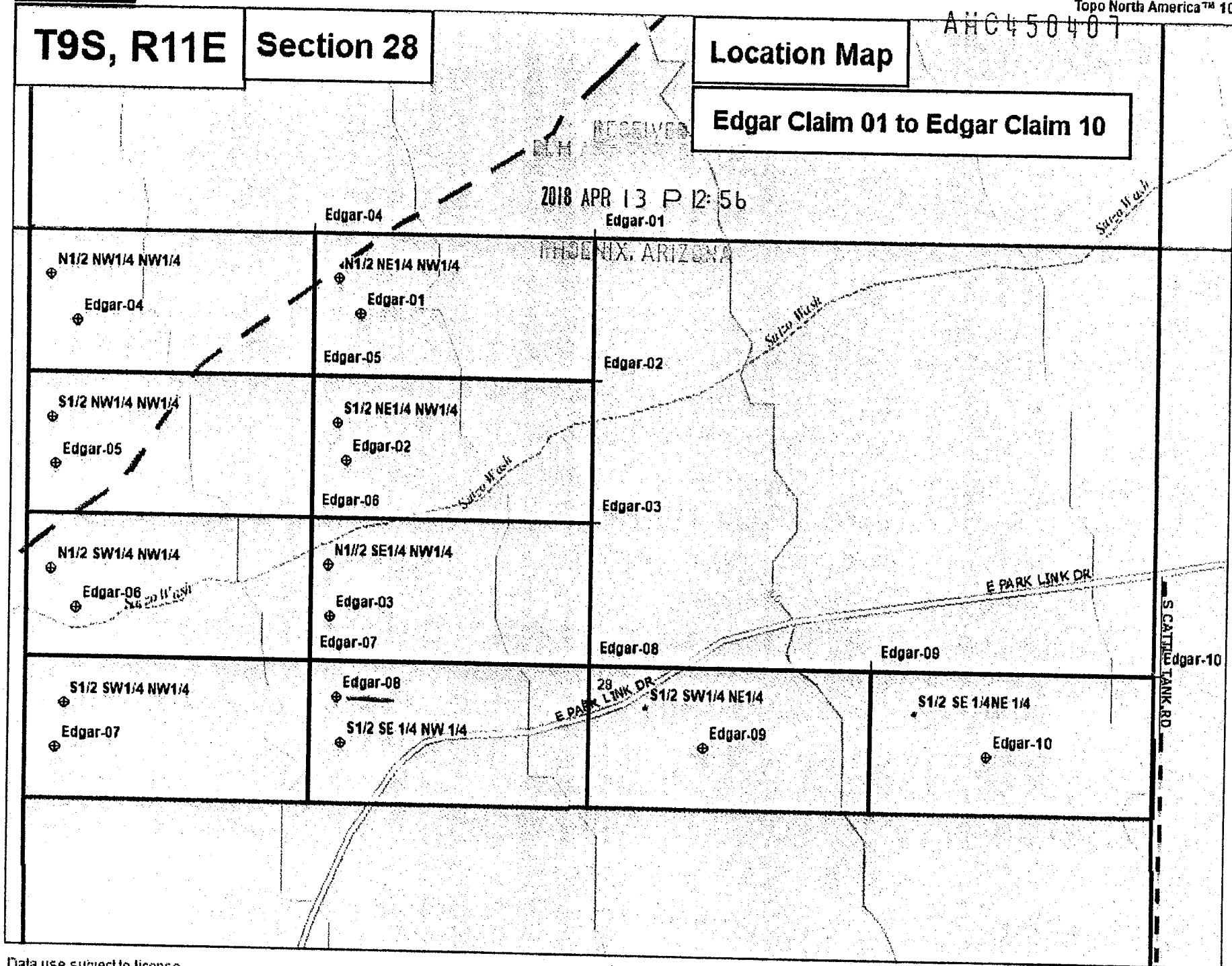

Data use subject to license.

© DeLorme. Topo North America™ 10.

www.delorme.com

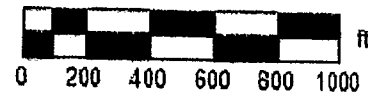

LOCATION NOTICE FOR PLACER MINING CLAIM

NOTICE IS HEREBY GIVEN that the Edgar-09 placer mining claim has been located by Edgar Henry whose current mailing address is 1012 Flatbush AVE. Brooklyn, NY 11223-5005.

BLM	2018 APR 13 P 12:56
DATE	2018 APR 13 P 12:56
STAMP	2018 APR 13 P 12:56

The general course of this claim is East to West and is situated in Pinal County, Arizona.

The claim is 1,320 feet in length and 660 feet in width. This claim runs from the location monument on which the location notice is posted (being the northeast corner of the said claim), approximately 660 feet in a southerly direction to the south end line and 1,320 feet in a westerly direction to the west end line.

The claim is marked by four 2"x2"x4' monuments, one at each corner of the claim.

The location monument on which this notice is posted is situated within Section 28, Township 9 South, Range 11 East, Gila Salt River Base and Meridian, Arizona. This claim encompasses portions of the following quarter section (s), section (s), Township (s) and Range (s)

S1/2 SW1/4 NE1/4 of Section 28, Township 9 South, Range 11 East, Gila Salt River Base and Meridian, Arizona.

The locality of this claim with reference to some natural object or permanent monument and additional information (if any) concerning its locality are as follows: NONE

DATED AND POSTED on the ground this 23 day of February, 2018.

LOCATOR (s) Owners

Edgar Henry

By

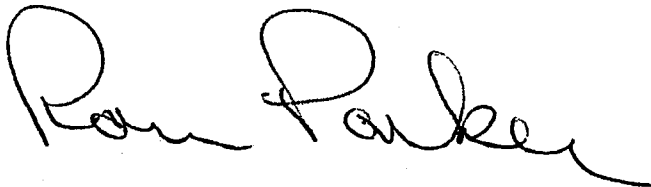

Ron Parker/Agent for Owners

AMC450408

T9S, R11E

Section 28

Location Map

AHC450408

Edgar Claim 01 to Edgar Claim 10

2018 APR 13 P 12:56

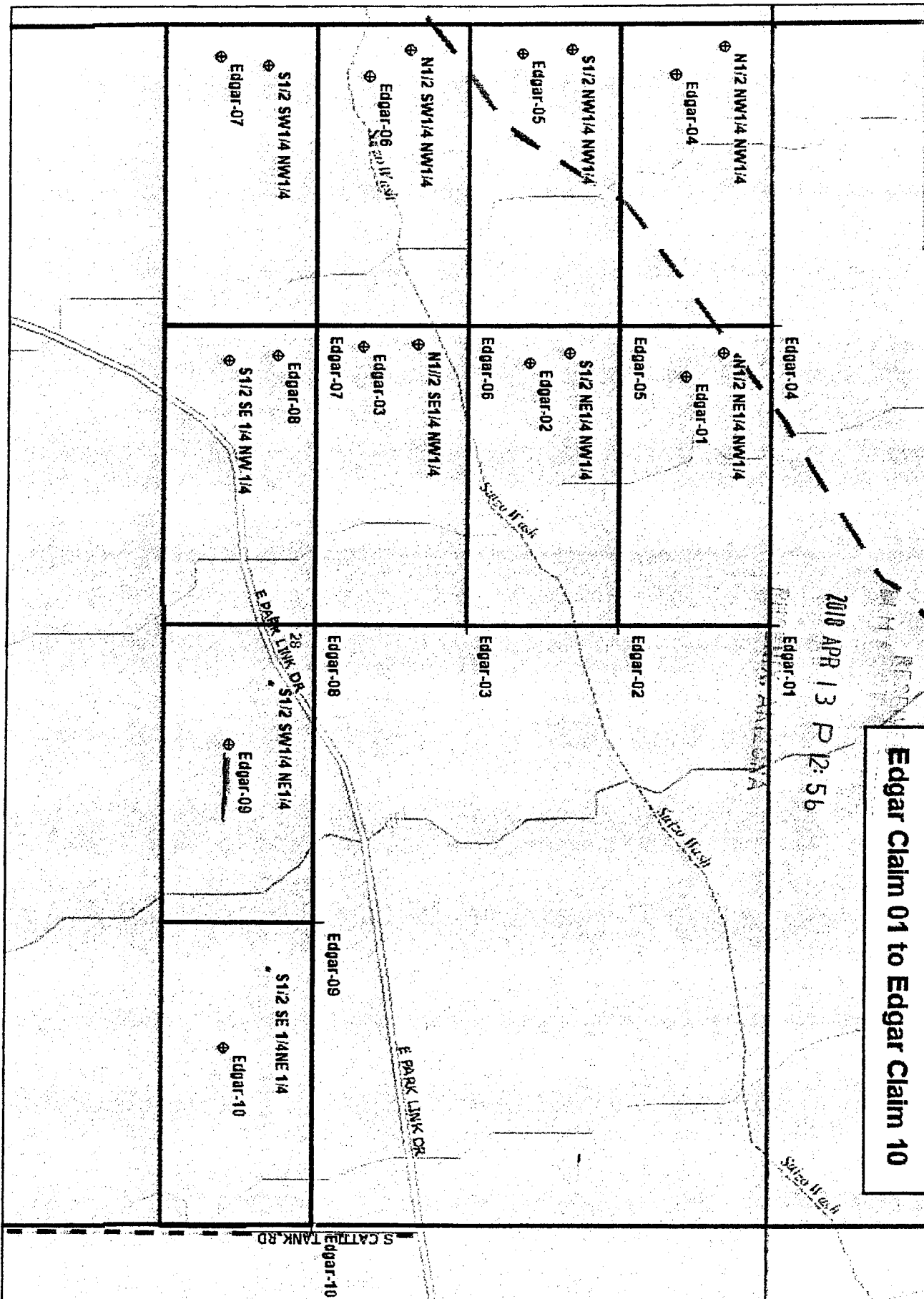

Data use subject to license.

© Delorme, Topo North America™ 10.

www.delorme.com

MN (9.9° E)



LOCATION NOTICE FOR PLACER MINING CLAIM

NOTICE IS HEREBY GIVEN that the Edgar-10 placer mining claim has been located by Edgar Henry whose current mailing address is 1012 Flatbush AVE. Brooklyn, NY 11223-5005.

BLM	
DATE	2010 APR 13 P 12:51
STAMP	

The general course of this claim is East to West and is situated in Pinal County, Arizona.

The claim is 1,320 feet in length and 660 feet in width. This claim runs from the location monument on which the location notice is posted (being the northeast corner of the said claim), approximately 660 feet in a southerly direction to the south end line and 1,320 feet in a westerly direction to the west end line.

The claim is marked by four 2"x2"x4' monuments, one at each corner of the claim.

The location monument on which this notice is posted is situated within Section 28, Township 9 South, Range 11 East, Gila Salt River Base and Meridian, Arizona. This claim encompasses portions of the following quarter section (s), section (s), Township (s) and Range (s)

S1/2 SE1/4 NE1/4 of Section 28, Township 9 South, Range 11 East, Gila Salt River Base and Meridian, Arizona.

The locality of this claim with reference to some natural object or permanent monument and additional information (if any) concerning its locality are as follows: NONE

DATED AND POSTED on the ground this 23 day of February, 2018.

LOCATOR (s) Owners

Edgar Henry

By



Ron Parker/Agent for Owners

ANHC450409

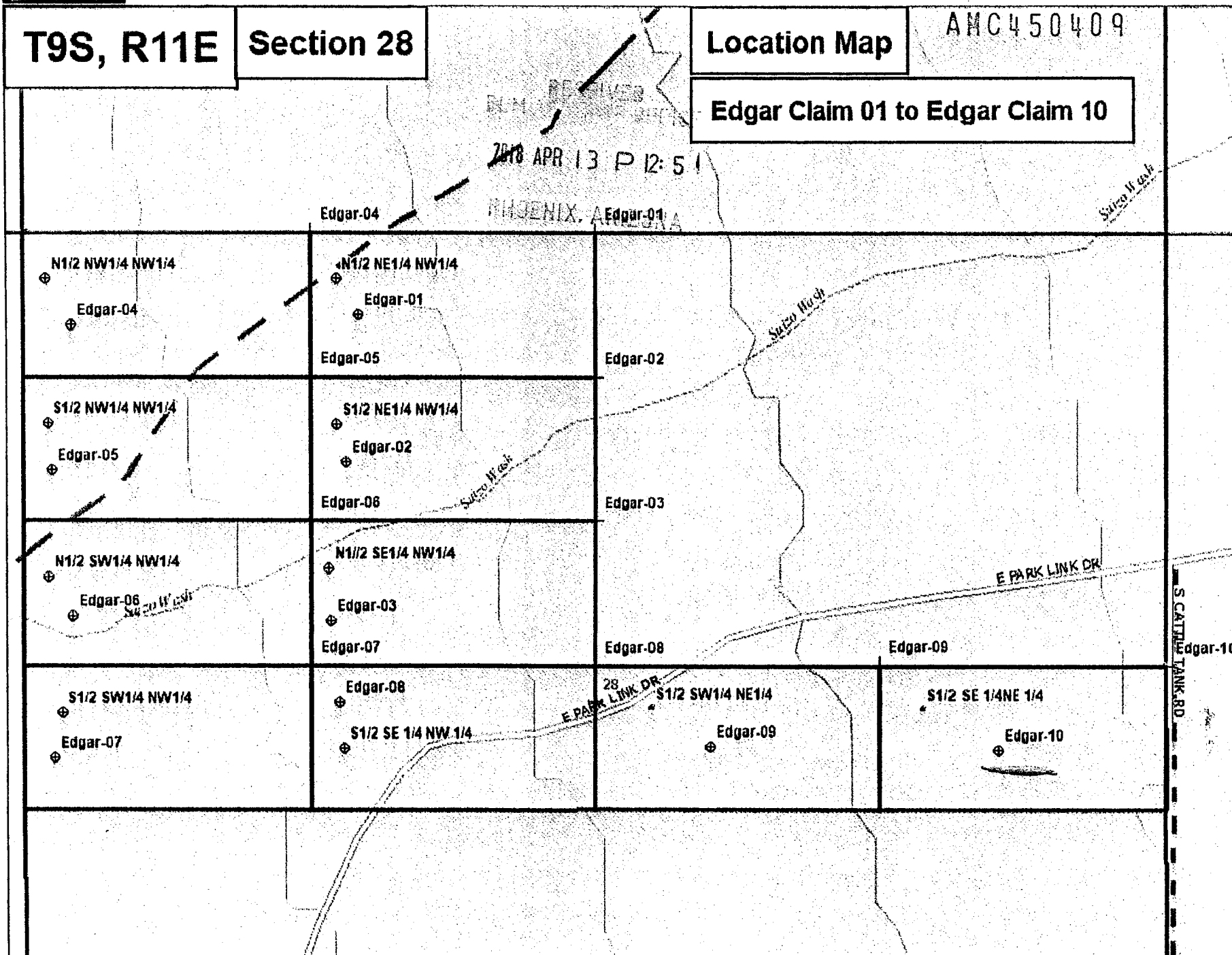

Data use subject to license.

© DeLorme, Topo North America™ 10.

www.delorme.com

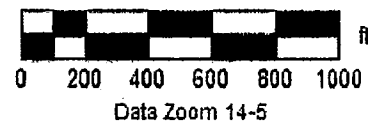

RUN TIME: 11:27 AM

DEPARTMENT OF INTERIOR
BUREAU OF LAND MANAGEMENT

RUN DATE: 04/19/2018
Page 1 of 1

Input Parameters for Geographic Report with Land

System Id = CR

Admin State = AZ

Geo State =

Casetype Begins With

Case Disp Txt = AUTHORIZED, CANCELLED, EXPIRED, PENDING, REJECTED, VOID, WITHDRAWN

Mer Twp Rng =

Section =

Mtrs = 14 0090S 0110E 028, 14 0090S 0110E 999

Commodity =

Commodity Txt =

Pending Org =

Pend Org Decode =

Total Rows Returned: 1

NO WARRANTY IS MADE BY BLM FOR USE OF THE DATA
FOR PURPOSES NOT INTENDED BY BLM

RUN TIME: 11:27 AM

Adm State: AZ

UNITED STATES DEPARTMENT OF INTERIOR
BUREAU OF LAND MANAGEMENT
GEOGRAPHIC REPORT WITH LAND
Sorted by Serial Number

RUN DATE: 04/19/2018
Page 1 of 1

Serial Number: AZA 021398

Total Case Acres: 75.760

<u>Casetype</u>	<u>Case Disp</u>	14	0090S	0110E	<u>Sect</u>	<u>Sur Typ</u>	<u>Sur Num</u>	<u>Suff</u>	<u>Subdivision</u>	<u>Act Pend</u>
282201	AUTHORIZED				028	ALIQ			S2N2,NW;	

Serial Number: AZA 022906

Total Case Acres: 62.860

<u>Casetype</u>	<u>Case Disp</u>	14	0090S	0110E	<u>Sect</u>	<u>Sur Typ</u>	<u>Sur Num</u>	<u>Suff</u>	<u>Subdivision</u>	<u>Act Pend</u>
281001	AUTHORIZED				028	MNR		1	E2NE,E2SE;	Y

PINAL COUNTY
TUCSON FIELD OFFICE

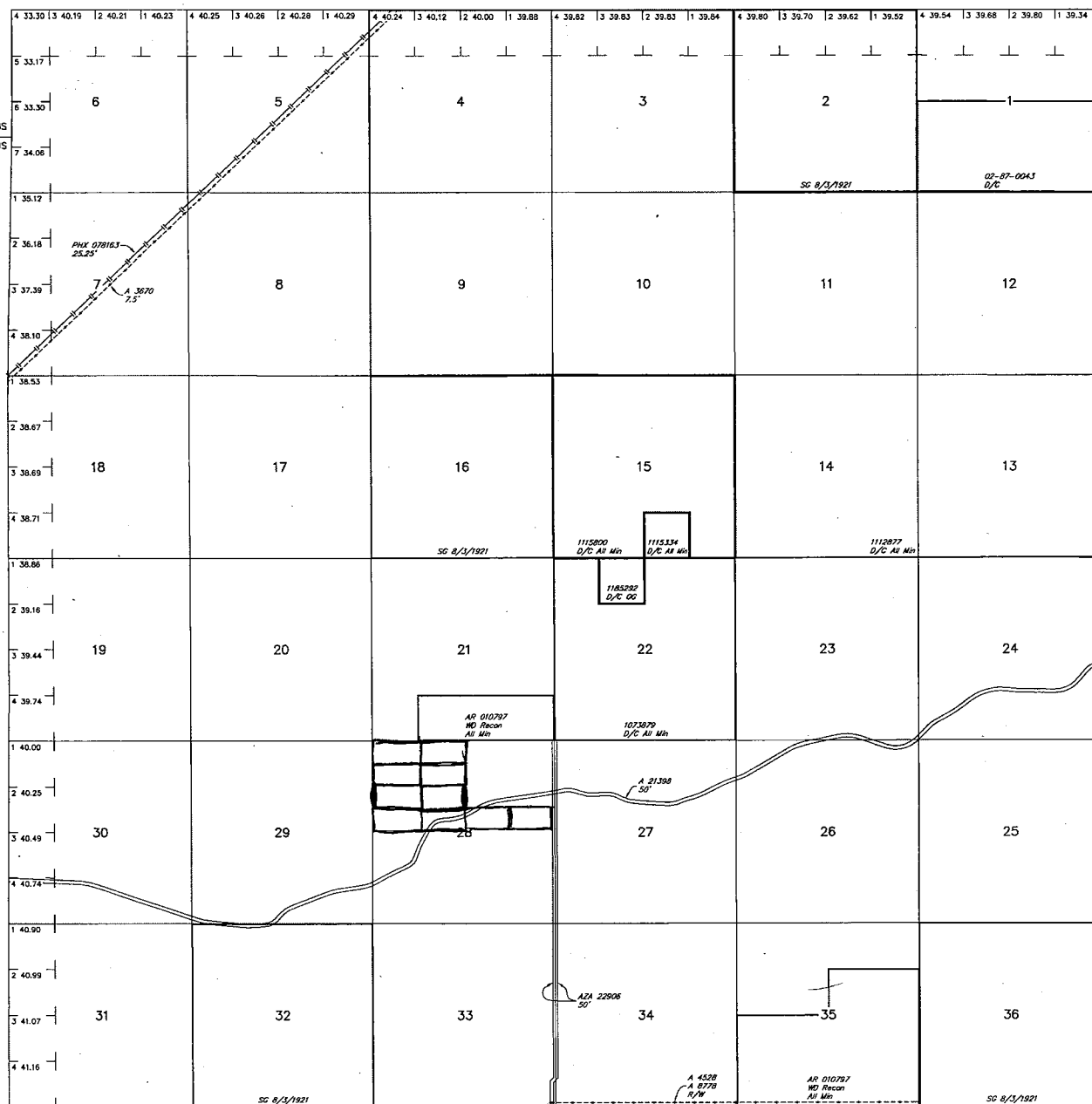
$$R = 10E \frac{T}{T_0}$$
[illegible]

FOR ORDERS AFFECTING DISPOSAL OR USE OF
UNIDENTIFIED LANDS WITHDRAWN FOR CLASSIFICATION,
MINERALS, WATER AND/OR OTHER PUBLIC PURPOSES,
REFER TO INDEX OF MISCELLANEOUS DOCUMENTS.

Lat	32°35'48"N
Long	111°09'08"W

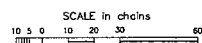

WARNING STATEMENT
This plot is the Bureau's Record of Title, and should be used only as a graphic display of the township survey data. Records hereon do not reflect title changes which may have been effected by lateral movements of rivers or other bodies of water. Refer to the cadastral surveys for official survey information.

CURRENT TO	LT	GSR Mer
8-31-2017	ACAD	T 9 S
		R 11 E

GSR Mer
T 9 S
R 11 E

Golden Oasis Development, LLC
7427 N. Syracuse St -
Portland, OR 97203



1021



85004

U.S. POSTAGE
PAID
PORTLAND, OR
97203
APR 10, 18
AMOUNT

\$1.84

R2305K136937-21

Bureau of Land Management
One North Central Ave.
Suite 800
Phoenix, Arizona 85004-4427

RECEIVED
BLM ADMINISTRATIVE OFFICE
2018 APR 13 P 12:54
PHOENIX, ARIZONA